

**LEGEND**

- FOUND IRON PIN
- ⊙ FOUND AXLE
- RIGHT OF WAY

**SURVEY FOR:**

Steve Galloway  
 17054 Harmon Road  
 Fayetteville, AR 72701  
 W.O.# 02104

**SURVEY BY:**

Engineering Services, Inc.  
 1207 S. Old Missouri Rd.  
 P. O. Box 282  
 Springdale, AR 72765

**LEGAL DESCRIPTION:**

A part of the North Half (N 1/2) of the Northwest Quarter (NW 1/4) of the Northeast Quarter (NE 1/4) of Section Nine (9), Township Seventeen (17) North, Range Thirty (30) West of the Fifth Principal Meridian, Washington County, Arkansas, and being more particularly described as follows, to wit:

Beginning at a found iron pin which is South 89°57'36" East - 208 feet from the Northwest Corner of said twenty acre tract; thence South 89°57'36" East - 199.01 feet to a Found Iron Pin; thence South 0°20'21" East - 208.00 feet to a Found Iron Pin; thence North 89°57'36" West - 199.01 feet to a Found Iron Pin, thence North 0°20'21" West - 208.00 feet to the POINT OF BEGINNING, containing 0.95 acres, more or less, and subject to the right-of-way of Washington County Road #886 along the North line of herein described tract.

**SURVEYOR'S CERTIFICATION:**

I hereby certify that the hereon platted and described survey was completed under my supervision on the 1st day of August, 2002, and that corners were set, as shown, to the best of my professional knowledge and ability.

This survey is made for the exclusive use of the present owner of the property, and also those who purchase, mortgage, or guarantee the title thereto, within one year from date hereof and as to them, warrant the accuracy of said survey and map.

*Philip C. Humbard* 12-23-02  
 Philip C. Humbard, Professional Land Surveyor  
 No. 1429, Arkansas

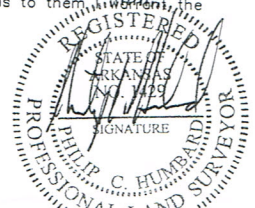

**SURVEYOR'S NOTE:**

This property is not within Zone A of the 100 year Flood Zone as shown on the F.I.R.M. Map #05143C0019C of Washington County, Arkansas, and Incorporated Areas dated September 18, 1991.

Any utility lines which may have been installed by previously granted rights-of-way or easements blanketing this property do not touch or cross this property except as shown hereon or except within the right-of-way and easement lines shown hereon.

Bearings on this survey are based on the bearings on a survey plat filed in Book E, Page 17.

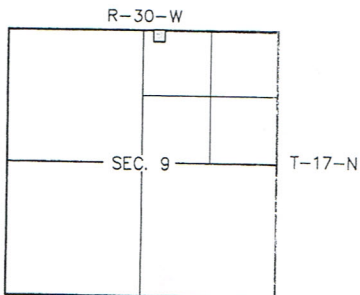

**LOCATION MAP**

REVISION	DATE	DESCRIPTION
1		

**PROPERTY SURVEY**  
 for **STEVE GALLOWAY**  
 SPRINGDALE, ARKANSAS

ENGINEERING SERVICES  
 INCORPORATED  
 1207 SOUTH OLD MISSOURI RD.  
 SPRINGDALE, ARKANSAS 72764

